

D365 CORNER DETAIL

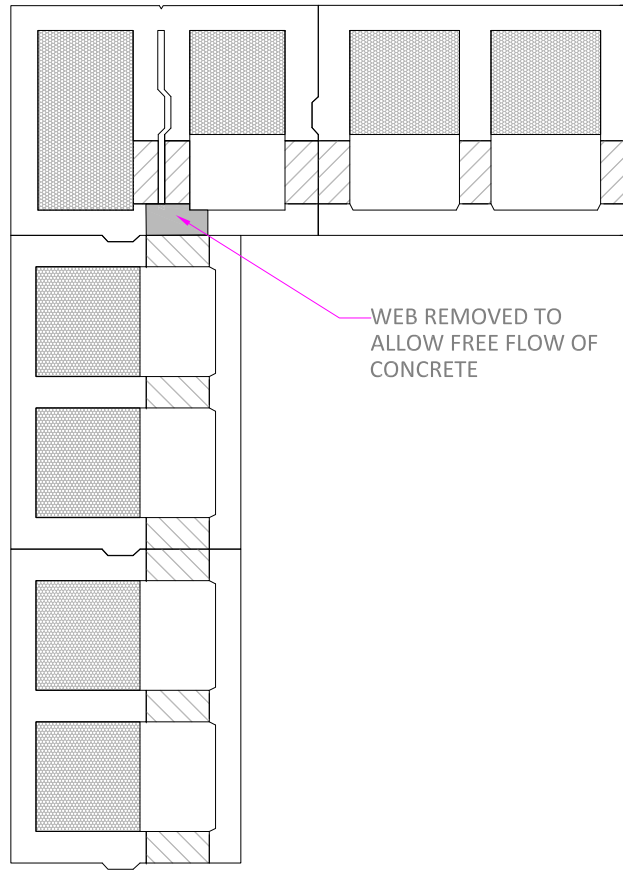

FIRST COURSE

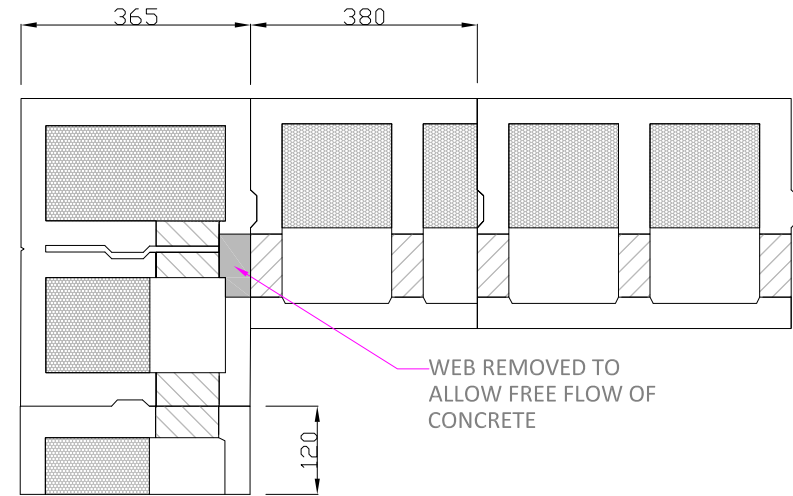

1 BLOCK CUT (380MM AND 120MM)
ACHIEVES BRICK BOND BELOW

SECOND COURSE



Durisol UK Ltd
Parkway, Pen-y-Fan Industrial Estate,
Crumlin, Gwent, NP11 3EF United Kingdom
T 01495 249 400
E enquiries@durisoluk.com
www.durisoluk.com

DURISOL TECHNICAL RESOURCES

DRAWING NUMBER: DTP013

REV: 2

NOT TO SCALE

FOR INFORMATION ONLY. ALWAYS USE A STRUCTURAL
ENGINEER FOR YOUR SPECIFIC PROJECT DETAILS